

# ACOUSTICAL LOUVER

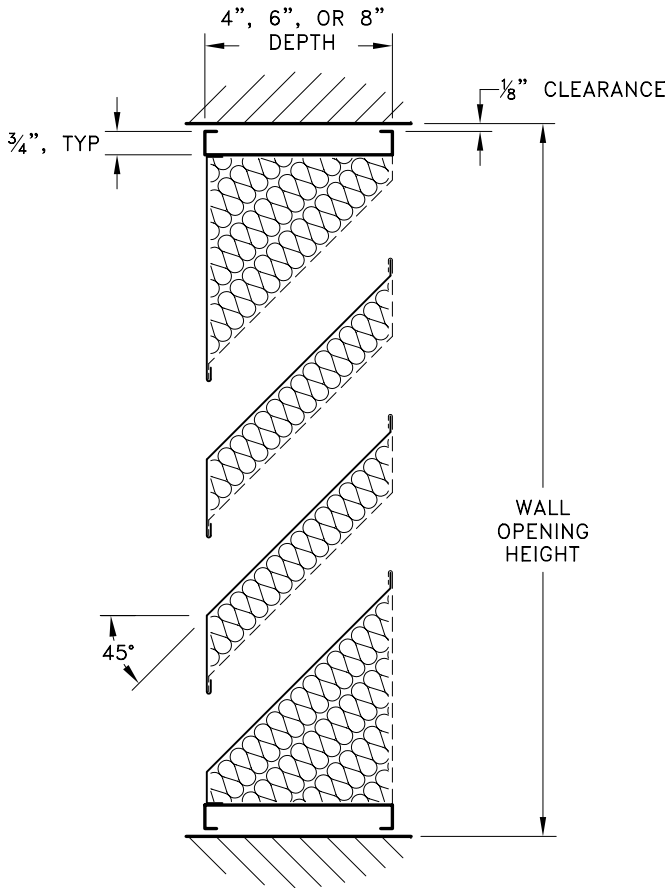

Noise Control Systems  
 P.O. Box 84763  
 Baton Rouge, LA 70884  
 (985) 892-7973 FAX 892-7196

A DIVISION OF THE RICHARD L. LOFTON COMPANY



## NCS 4-6-8-36-R

FABRICATED

45° BLADE - 4", 6", or 8" DEPTH

### SPECIFICATIONS

FRAME: 18 guage galvanized steel channel.

BLADES: 18 guage galvanized steel.

BLADE SPACING: 5" standard.

FINISH: Mill finish standard.

### SIZES

MINIMUM: 24" x 24"

MAXIMUM: Louvers larger than 96" high x 72" are made in sections with mullions, making size unlimited.

DEPTH: 4", 6", or 8" frame, standard.

### OPTIONS

FLANGE FRAME: 2" Flange standard,  
Other sizes available.

MATERIAL: Aluminum, Stainless Steel, and heavier guage galvanized steels available.

SCREEN: 1/2" x 1/2" 19 guage galvanized mesh.  
Other size and material screens available.

FINISH: A. Prime coat.

B: Color coat, see color chart.

PROJECT \_\_\_\_\_

LOCATION \_\_\_\_\_

ENGINEER \_\_\_\_\_

CONTRACTOR \_\_\_\_\_

REVISIONS \_\_\_\_\_

### ACOUSTIC PERFORMANCE

BASED ON 6" DEPTH

OCTAVE BAND	1	2	3	4	5	6	7	8
CENTER FREQUENCY. Hz	63	125	250	500	1K	2K	4K	8K
TL. dB	6	9	10	11	15	19	17	16
NR. dB	12	13	16	18	21	25	26	24

### AERODYNAMIC PERFORMANCE

BASED ON 6" DEPTH

PRESSURE LOSS, iwg	.05	.15	.20	.35	.45	.60	.75	1.0
FACE VELOCITY, fpm	118	205	237	313	355	410	458	529

NOTE: Louver will be supplied 1/4" smaller than width and height dimensions shown below.

QTY	WALL OPENING WIDTH-HHEIGHT	DEPTH	NO. OF SECTIONS	SILL TYPE	FINISH	REMARKS AND OPTIONS